

## Global Guest House -Floor Plan and Photos (wheelchair-accessible room)

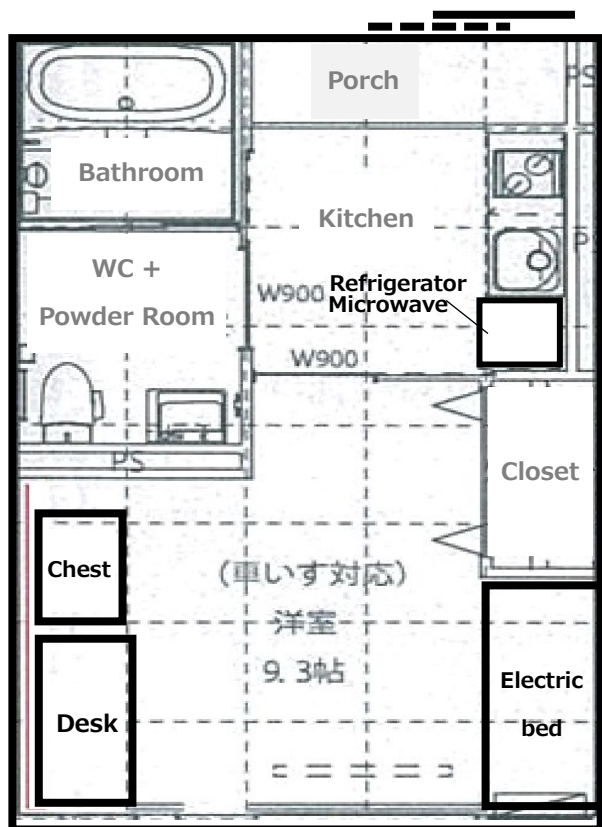

Floor Plan (33 m<sup>2</sup>)

※The layout of the room may vary from actual.



① Bathroom



② Toilet



③ Kitchenette



④ Electric bed

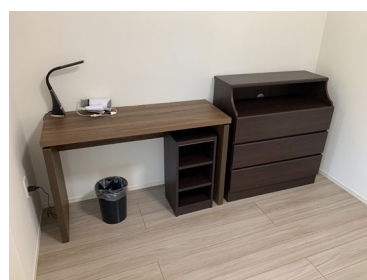

⑤ Desk, Rack, Chest

### Facilities and Equipment etc.

Facilities And Equipment	Guest House	Desk, electric bed, rack, chest, closet, air conditioner, unit bath, toilet, kitchenette, hairdryer, refrigerator, microwave, electric kettle, and Internet (Wi-Fi)
	Monthly Guest House	Desk, electric bed, rack, chest, closet, air conditioner, unit bath, toilet, kitchenette, hairdryer, refrigerator, microwave, and Internet (Wi-Fi)
Amenities	Guest House	Bedding items, towel, bath towel, toothbrush set, razor, shampoo, rinse, etc., are also provided.
	Monthly Guest House	None *Bedding items, towel, bath towel are available for rent. (Bedding rental charge(3,850yen per month) is required.)
Shared Facilities	Laundry Room	Washing machine and dryer Charges: 100 yen per use

※ If you need bathrobes, bring one or you can rental for 300yen per piece.

※ At time of check in, bed should be made by yourself.

※ Tableware (paper cups, paper plates, chopsticks, forks, spoons, and hand towels) can be provided to those who wish to use them.